

EXPANSION & RENOVATE AS NEW – PHASE 1

**CRYSTAL LAKE ELEMENTARY SCHOOL
284 SANDY BEACH ROAD
ELLINGTON, CT 06029
STATE PROJECT NO. 048-0058 EA/RR/PS**

S/P+A PROJECT NO. 12.140

DATE: December 31, 2013

The following changes to the Drawings and Project Specifications shall become a part of the Drawings and Project Specifications; superseding previously issued Drawings and Project Specifications to the extent modified by Addendum No. 3.

General Information/Clarifications:

- See attached RFIs. (6)

Changes to the Specifications:

- Refer to the attached RFIs for any changes to the specifications

Changes to the Drawings:

- Drawing A724, INTERIOR ELEVATIONS, change all wood finish references on this drawing from WD1 to WD2, and refer to Section 090000 of the project manual for more information.

New Drawings:

- DRAWING SK A1, Music Room Panels.
- DRAWING SK A2, Aluminum Curtain Wall Frames.

The bid dates are unchanged by this addendum.

The addendum consists of seven (7) pages of 8½” x 11” text and two (2) 8 ½ x 11 drawings.

End of Addendum #3

GERBER CONSTRUCTION

1 Nutmeg Dr.
Ellington, CT 06029
AA/EOE
(860) 875-6684
ron@gerberconstructioninc.com

RFI # 001

RFI

TO:	Paul Jorgensen <pjorgensen@silverpetrucelli.com>	FROM:	Benjamin Luginbuhl
EMAIL:	RSteiner@Fusco.com	# PAGES:	1
COPY:	Ron Gerber	PHONE:	8608756684
SUBJECT:	BID PACKAGE-SITEWORK	DATE:	12/17/13

QUESTION: We realize that C. Welti calls for 16" of 6.0 spec controlled structural fill beneath the building slab on grade. **Question #1:** Will the onsite fill from the "cut" areas be acceptable to be placed within the building footprint below the 16" of controlled structural fill?
Question #2: Will the onsite fill from the "cut" areas be acceptable to be placed below the subgrade of the parking lots, walks and driveways?

Response:

The onsite fill is not suitable for use under the building or under paved parking areas/associated embankments. It is suitable for use as fill in the fields and over the fire tank. The cuts over four (4) feet in the southernmost part of the southern field will most likely be wet. If this material is to be reused as fill in the previously mentioned areas, it is critical that the contractor make provisions for it to drain to the point that it can be properly compacted (90% per Specification 31 2310, Section 3.8.G.7).

Paul Jorgensen
Silver Petrucelli + Associates
12/18/2013

Paul Jorgensen

From: Paul Jorgensen
Sent: Wednesday, December 18, 2013 9:36 AM
To: 'Carl Ponticello'
Subject: RE: CRYSTAL LAKE ELEM SCHOOL

Carl,

The following is our response, which will be included in the next addendum:

**Core material requirements are found in 064116-5 2.2A (and B)
Hinges are found in 064113-4 2.4A**

Paul Jorgensen, AIA
Associate/Project Architect

www.silverpetrucelli.com

SILVER / **PETRUCELLI + ASSOCIATES**
Architects/Engineers/Interior Designers

3190 Whitney Avenue Bldg 2
Hamden, Connecticut 06518
P: 203-230-9007 ext. 208
F: 203-230-8247
M: 203-435-7447
S/P+A is a member of the U.S. Green Building Council

From: Carl Ponticello [mailto:carl@hneequipment.com]
Sent: Wednesday, December 18, 2013 9:15 AM
To: Paul Jorgensen
Subject: CRYSTAL LAKE ELEM SCHOOL

HELLO AGAIN PAUL

ANOTHER QUESTION ON THE ABOVE PROJECT.

SECTION #064116 / PLASTIC LAM CABINETS
WHAT IS THE CORE MATERIAL AND WHAT TYPE OF HINGES ARE REQUIRED ON THE LAMINATE CABINETS...????

PLEASE ADVISE

Carl Ponticello

carl@hneequipment.com

H & E EQUIPMENT CORP.
1493 CHURCH STREET
HOLBROOK, N.Y. 11741

Paul Jorgensen

From: Paul Jorgensen
Sent: Thursday, December 19, 2013 9:06 AM
To: 'Vincent@ldmechinsulation.com'
Cc: Rebecca Bouchard
Subject: FW: Crystal Lake Elementary MEP RFI

Vincent, please see RFI responses below. Let us know if you have any further questions. –Paul Jorgensen, Silver Petrucelli + Associates

From: Martin J. Cashin
Sent: Thursday, December 19, 2013 7:10 AM
To: Paul Jorgensen
Cc: Rebecca Bouchard
Subject: RE: Crystal Lake Elementary MEP RFI

1. There are two different types of 'exhaust' duct. One would be general bathroom type exhaust which does not need to be insulated. The other would be exhaust duct from a dedicated outdoor air system which would need to be completely insulated.
2. Insulation in the attic space would need to be insulated to a value of R-8 per the energy code. Since it is not exposed to the elements no additional protection such as an aluminum jacket would be required. Therefore fiber blanket insulation is acceptable, as long as the R-8 value is maintained.

From: Vincent Dimella [<mailto:Vincent@ldmechinsulation.com>]
Sent: Tuesday, December 17, 2013 12:51 PM
To: Dean Petrucelli
Subject: Crystal Lake Elementary MEP RFI

Mr. Petrucelli,

In regards to the above referenced project, we would like to submit the following request for information;
Re. Section 230713

1. Paragraph 1.2 A. 7. Indicates exposed exhaust to be insulated between isolation damper and penetration of building exterior. However, paragraph 3.11 N. indicates all exposed exhaust air requires insulation. Please clarify.
2. In regards to MEP insulation, is the attic space considered an exposed space, therefore requiring Mineral-Fiber Board insulation, or is Mineral-Fiber Blanket acceptable?

Thank you.

*Regards,
Vincent DiMella
L&D Mechanical Insulation Inc.
Taugwonk Spur, Building #34
Units #9 & #10
Stonington, CT
p – (860) 535 - 9828
f – (860) 535-9826
c – (860)449 - 4717
D.A.S. Certified Woman Owned
Small/Minority BusinessEnterprise*

From: Andrew Barszcz
Sent: Tuesday, December 31, 2013 7:49 AM
To: 'rbouchard@silverpetrucelli.com'
Subject: crystal lake elementary school - rfi 1

1. Specification section 023219 – Exploratory excavations, subsection 1.2.B “ Exploratory excavation requested by Engineer shall be paid for in accordance with Contractor’s Unit Price bid for “Exploratory Excavations” per section 01200-Unit prices”. There is no ‘Exploratory Excavations” line item in the Unit Prices section of the Bid Form. Please advise.

Andrew Barszcz
Estimator
Rizzo Corporation

64 Triangle Street
Danbury, CT 06810

203-731-3132, ext 1808
203-748-8747-fax

RFI Response from BSC, Civil Engineers

From: Walter, William G. [<mailto:wwalter@bscgroup.com>]
Sent: Tuesday, December 31, 2013 9:15 AM
To: David Stein
Cc: Rebecca Bouchard; Paul Jorgensen; William Silver
Subject: RE: crystal lake elementary school - rfi 1

“There are existing underground utilities, most of which have been located based on record information. The contractor shall include, in his base bid, all exploratory excavations necessary for the Contractor to determine exact location of existing underground utilities, as required for completion of the Bid Documents. The Engineer will not initiate any exploratory excavations.”

Therefore, delete the references in Specification section 023219 – Exploratory excavations, subsection 1.2.B of “.....Contractor’s Unit Price bid for “Exploratory Excavations”. No unit prices will be sought for Exploratory Excavations.

Thanks,

Will Walter, PE, LEED AP | Manager of Civil Engineering

From: Joseph Petronella [<mailto:jjpetronella@enfieldbuilders.com>]
Sent: Monday, December 30, 2013 3:01 PM
To: Joan Ireland
Subject: 3 more questions - Crystal Lake

Hi Joan, can you ask these too?

1. Spec 090000-4, WOM-3: Please confirm that Vestibule C131 should be C146.
2. Spec 122413, 2.3: Provide locations of motor operated shades.
3. Spec 090000-13, RS-1 symbol: Provide locations for any shades required at interior doors and sidelights.

Joe

Thank you,

Joseph Petronella
Estimating/Purchasing

Enfield Builders, Inc.

GENERAL CONTRACTORS • CONSTRUCTION MANAGERS

1654 King Street • PO Box 1201 • Enfield, CT • 06083

Tel (860) 627-6870 • Fax (860) 627-8017

www.enfieldbuilders.com

RFI Response from Silver Petrucelli and Associates, Inc. on 12/31/13.

1. Yes, Vestibule C131 should be C146.
2. Spec 122413, 2.3: Add the following: "Locations of motor operated shades shall be at all high clerestory Media Center windows and in the tall media center windows, Room C141. Add to the electrical power plans the following note: Provide 120 volt single phase circuits to each of the motorized shades in the media center Room C141."
3. Spec 090000-13, RS-1 symbol: add the following: "Provide manually operated shades at all interior doors with glazing and at all interior sidelights."

From: Carl Ponticello [<mailto:carl@hneequipment.com>]
Sent: Tuesday, December 17, 2013 2:11 PM
To: Paul Jorgensen
Cc: 'Thomas Doughty'
Subject: CRYSTAL LAKE ELEM SCHOOL

PAUL...

AS PER OUR DISCUSSION EARLIER TODAY, I HAVE A FEW QUESTIONS ABOUT THE CASEWORK ON THE ABOVE PROJECT.

RFI RESPONSES FROM SILVER PETRUCELLI AND ASSOCIATES, INC. ON 12/31/13.

SECTION #123553.15 CALLS FOR PHENOLIC CASEWORK [ROOM#A124 / SCIENCE LAB].... BUT IF YOU GO TO THE ELEVATIONS ON SHEET #A720 IT SHOWS WOOD CASEWORK. **CHANGE THE SPECIFICATION TO READ THAT ROOM A124 IS TO BE WD1, CONSISTENT WITH THE FINISHES IN SECTION 090000 OF THE PROJECT MANUAL.**

ALSO ON SHEET A720 ELEV.#12 / ART ROOMTHAT ROOM CALLS FOR PHENOLIC CASEWORK... IS THAT CORRECT..?? **PHENOLIC IS THE CORRECT FINISH FOR THE ART CLASSROOM.**

IS IT POSSIBLE TO GET A BREAKDOWN OF WHAT ROOMS GET ...LAMINATE, WOOD AND PHEONOLIC CASEWORK..?? **THE BREAKDOWN OF THESE FINISHES IS FOUND IN SECTION 090000 OF THE PROJECT MANUAL.**

PLEASE ADVISE

THANKS FOR THE HELP

Carl Ponticello

carl@hneequipment.com

H & E EQUIPMENT CORP.
1493 CHURCH STREET
HOLBROOK, N.Y. 11741
PHONE 631-563-6500
FAX 631-563-6502

Project Title:

Expansion & Renovate as New
Crystal Lake Elementary School
284 Sandy Beach Road
Ellington, Connecticut 06029



SILVER/PETRUCELLI + ASSOCIATES
Architects / Engineers / Interior Designers
3190 Whitney Avenue, Hamden, CT 06518-2340
Tel. 203 230 9007 Fax. 203 230 8247
silverpetrucci.com

Drawing Title:

Music Room
Acoustic Panels

Date:

12/16/2013
Scale:
AS NOTED
Drawn By:
PEJ
Project Number:
12.140

Drawing Number:
SKA1
Bid Phase

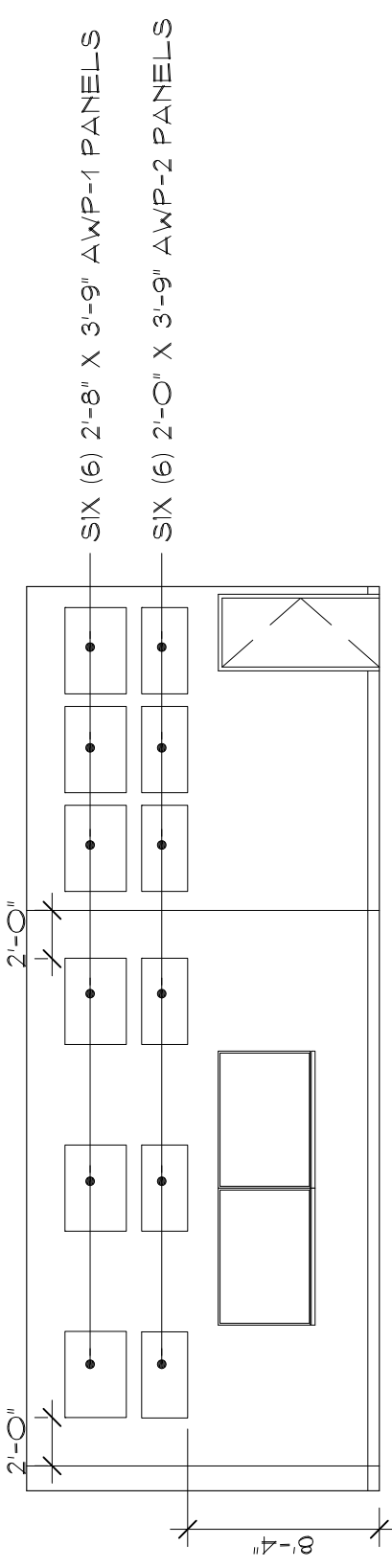

INTERIOR ELEVATION FACING SOUTH

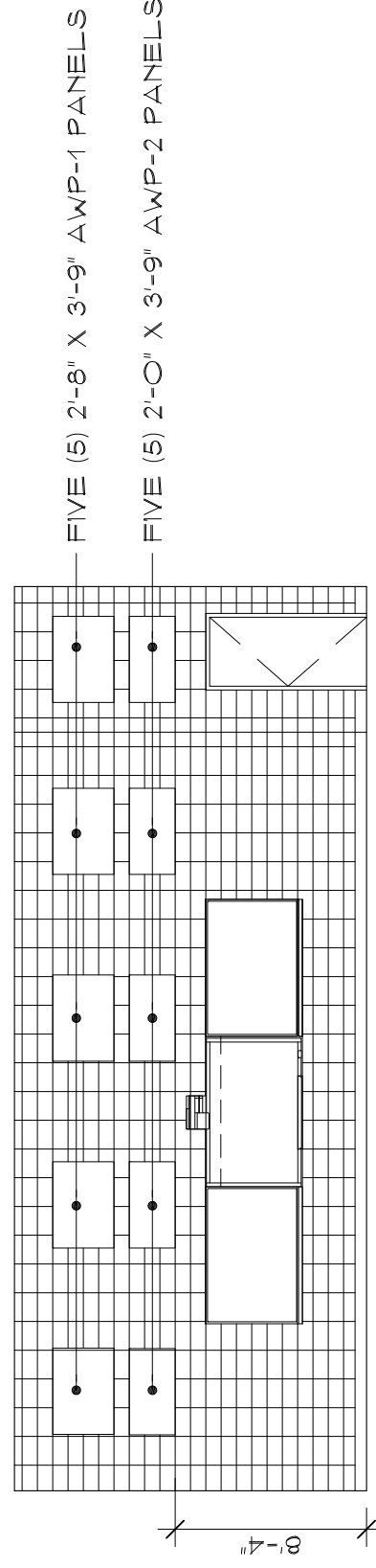

INTERIOR ELEVATION FACING NORTH

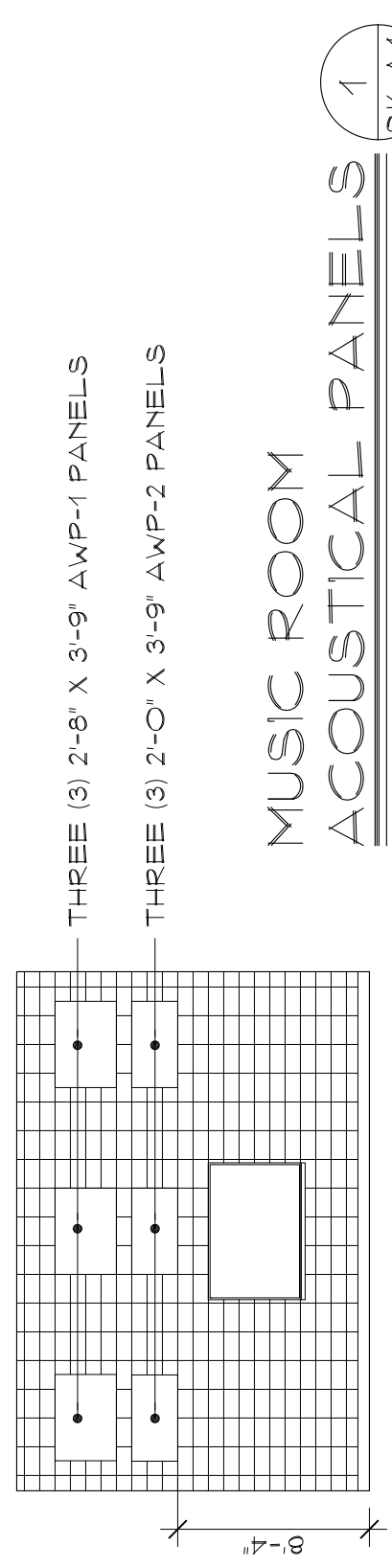

INTERIOR ELEVATION FACING WEST

MUSIC ROOM ACOUSTICAL PANELS

SCALE: 1/8" = 1'-0"

